

Meetings & Conventions Hotels

Pick Lexington as your meeting destination and you have a wide range of hotels from which to choose. You are sure to find the property with the right location and amenities to suit your needs.



- Best Western Regency Inn
- Comfort Inn
- Comfort Suites Beaumont Center
- Courtyard North
- Crowne Plaza Lexington - The Campbell House
- Embassy Suites
- Four Points Sheraton
- Griffin Gate Marriott Resort
- Hilton Suites Lexington Green
- Holiday Inn North
- Holiday Inn South
- Hyatt Regency Lexington
- The Kentucky Inn
- Radisson Plaza Hotel
- Ramada Conference Center
- Sheraton Suites Lexington
- SpringHill Suites
- The Springs Inn

Best Western Regency Inn

2241 Elkhorn Road, Lexington, KY 40505 Tel 859/293-2202 Fax 859/293-1821 www.bestwestern.com

This convenient hotel is located off two interstate highways, I-75 and I-64. Professional conference capabilities enhance meetings and special gatherings.

Name of Room	Square Feet	Capacity			
		Theatre Style	Classroom Style	Banquet	Reception
Regency Room	1,300	125	60	96	—
Regency East	620	60	32	36	—
Regency West	680	60	32	36	—

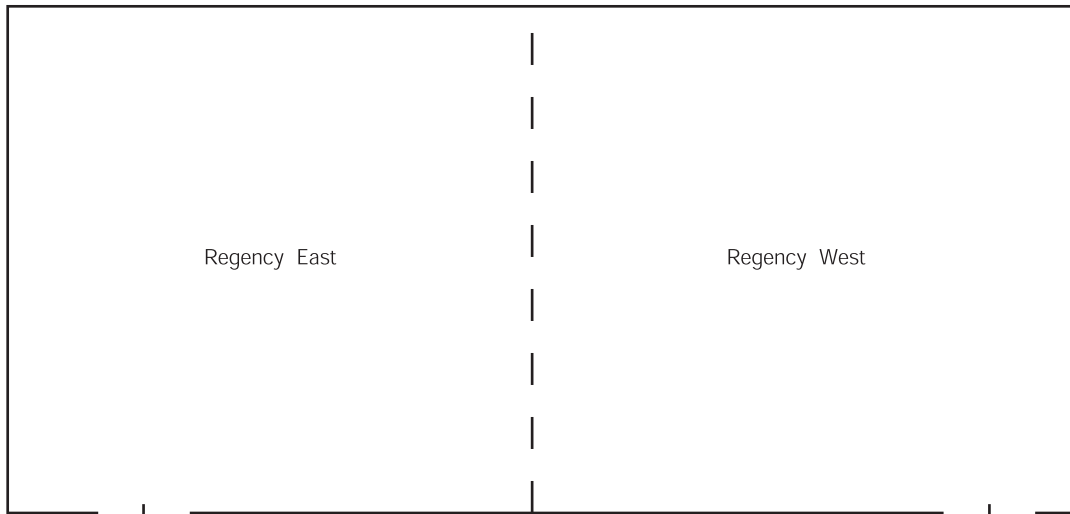

Lobby/
Restrooms

Comfort Inn

2381 Buena Vista Drive (Exit 110, I-75), Lexington, KY 40505 Tel 859/299-0302 800/394-8403 Fax 859/299-2306 www.comfortinn.com
 Convenient to Lexington's newest retail and dining development, Hamburg Pavilion, the Comfort Inn features an indoor pool with pool-side Jacuzzi and is suitable for smaller meetings.

Name of Room	Square Feet	Capacity			
		Theatre Style	Classroom Style	Banquet	Reception
PCC	930	90	48	—	—
EMR	600	40	21	—	—
Boardroom	300	14 person capacity			

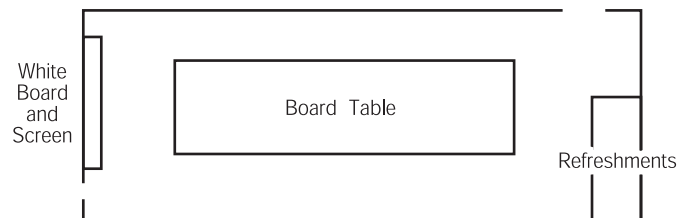
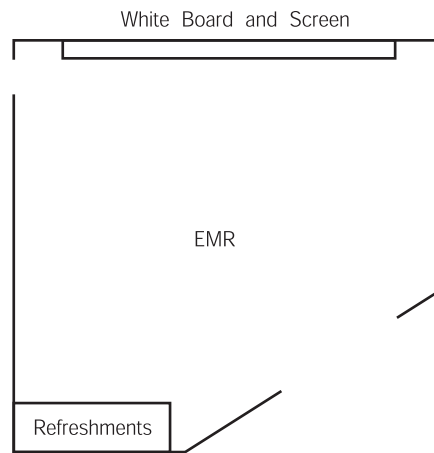
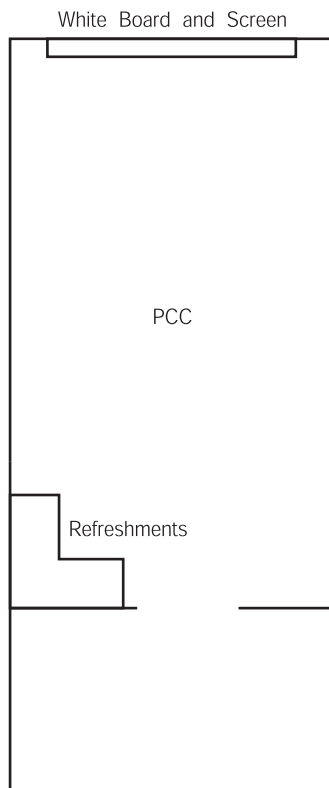

Comfort Suites Beaumont Center

3060 Fieldstone Way, Lexington, KY 40513 Tel 859/296-4446 800/228-5150 Fax 859/296-1404 www.hotelchoice.com

The Comfort Suites at Beaumont Center's proximity to Keeneland Race Course makes it the perfect choice for smaller meetings that take place during the spring or fall race meets.

Name of Room	Square Feet	Capacity			
		Theatre Style	Classroom Style	Banquet	Reception
First Floor Meeting Room	600		35 person capacity		
Second Floor Meeting Room	300		12 person capacity		

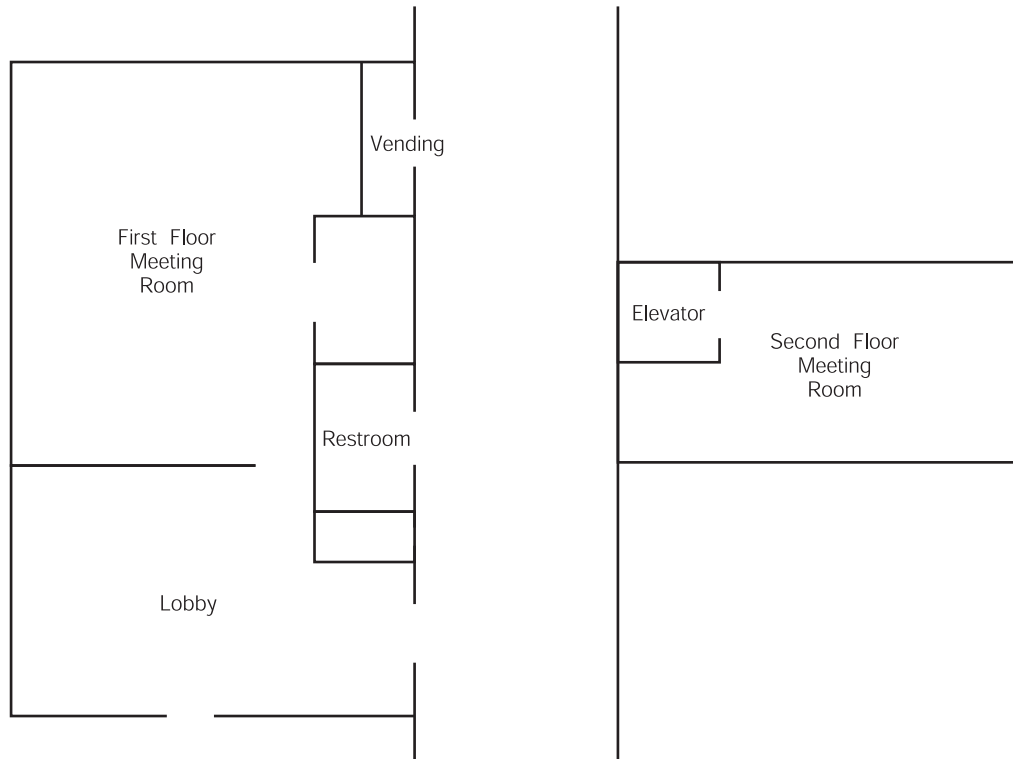

Courtyard North

775 Newtown Court (Exit 115, I-75), Lexington, KY 40511 Tel 859/253-4646 800/321-2211 Fax 859/253-9118 www.courtyard.com
 Just minutes away from the region's largest attraction, the Kentucky Horse Park, this full service hotel is an excellent choice for smaller meetings.

Name of Room	Square Feet	Capacity			
		Theatre Style	Classroom Style	Banquet	Reception
Meeting Room A	637	40	27	40	60
Meeting Room B	637	40	27	40	60

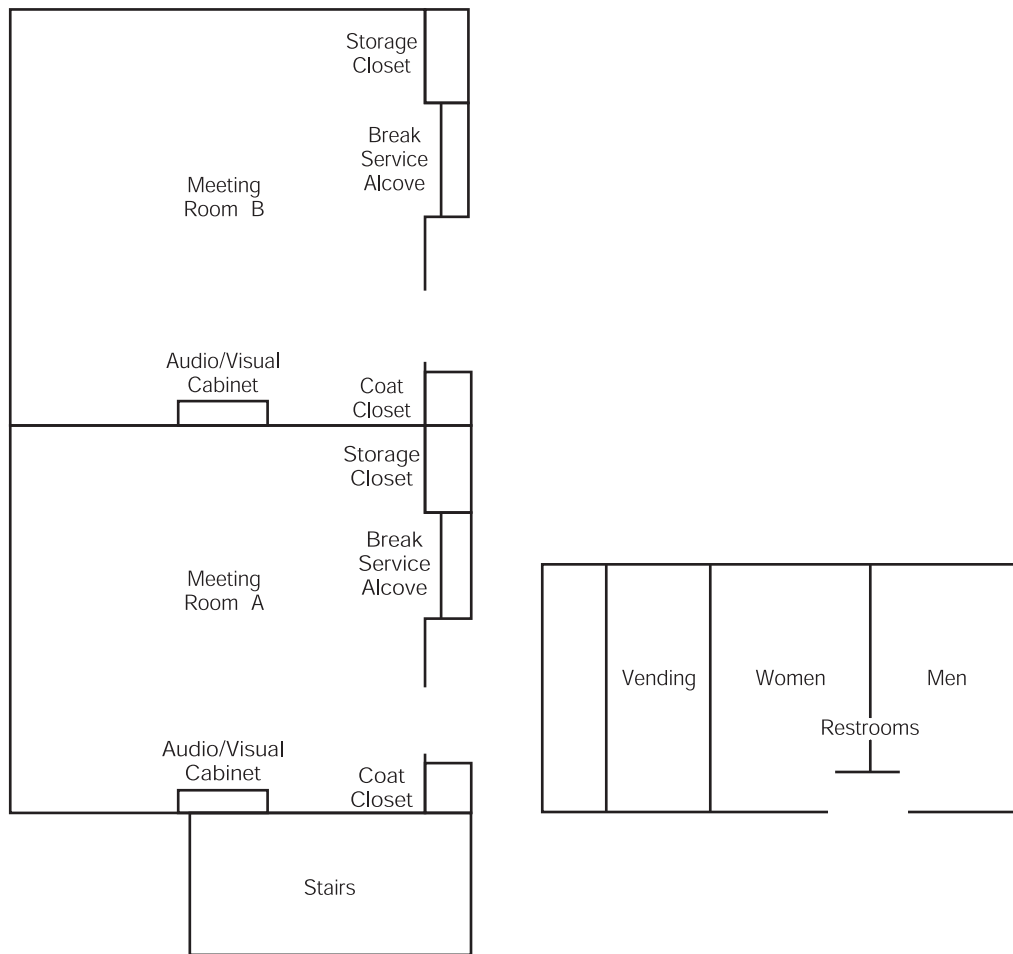

Crowne Plaza Lexington - The Campbell House

1375 Harrodsburg Road, Lexington, KY 40504 Tel 859/255-4281 800/2CROWNE Fax 859/254-4368
www.crowneplaza.com/campbellhouse

This established full-service hotel offers amenities and meeting rooms for groups of 10 to 500. Located 1.5 miles from downtown Lexington, there's entertainment nightly in the lounge, tennis courts and a golf course adjacent to the grounds. It's a quick 10-minute drive to the airport and historic Keeneland Race Course, the Red Mile Harness Track, and much of the University of Kentucky.

Name of Room	Square Feet	Capacity				Ceiling Height	Exhibit (8x10)
		Theatre Style	Classroom Style	Banquet	Reception		
Colonial Prefunction	1,200	—	—	—	100	11'	—
Colonial	5,280	500	275	300	400	11'	125
Colonial A	836	100	50	50	80	11'	—
Colonial B	1,804	225	130	125	200	11'	—
Colonial C	2,332	250	160	165	250	11'	—
Paddock Room Prefunction	625	30	—	20	50-75	11'	—
Paddock Room	2,505	200	120	140	250	11'	—
Mason-Headley	1,296	80	60	80	100	11'	—
Terrace	832	60	50	40	50	11'	—
Magnolia	975	70	60	60	70	11'	—
Turf	600	50	35	40	40	11'	—
Oak Room	494	40	16	20	40	11'	—
Summit Room	2,948	50/40	30/30	70	120	—	—

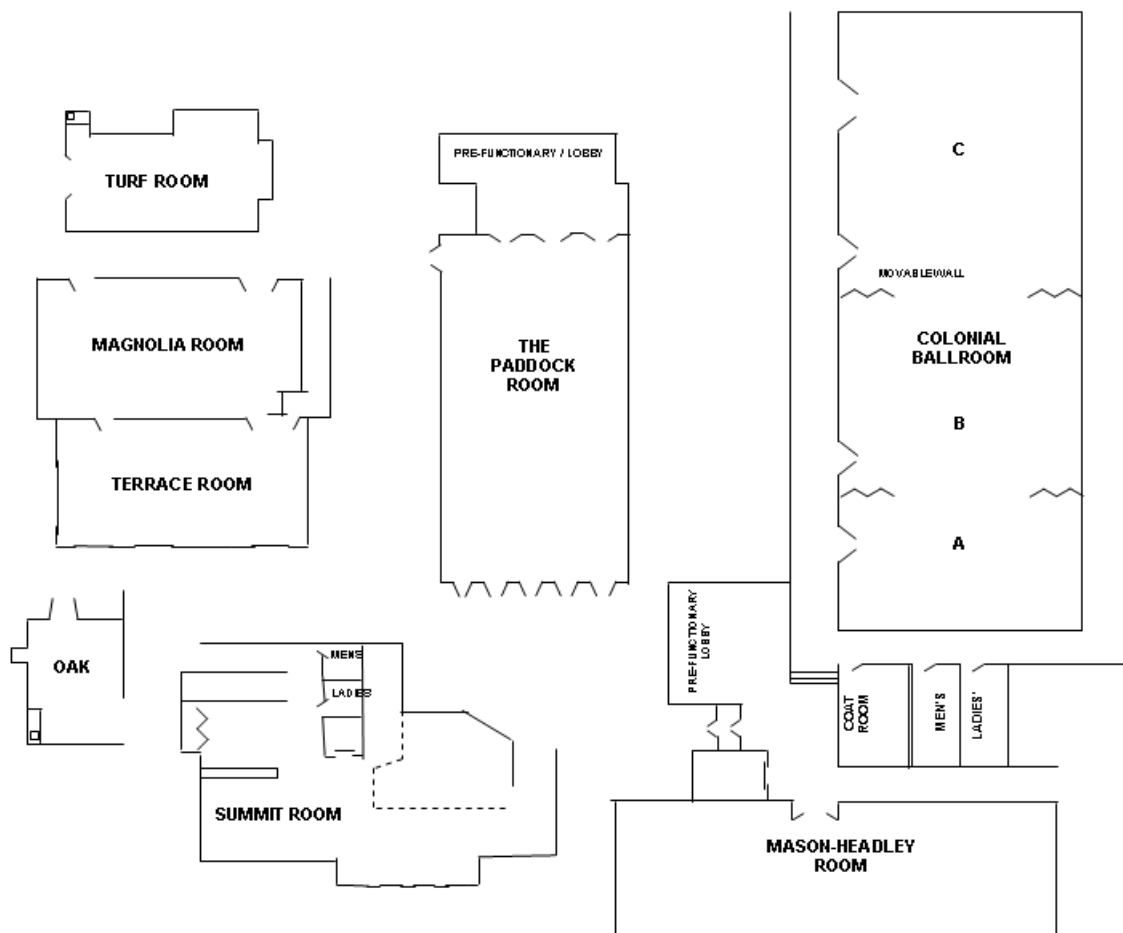

Embassy Suites

1801 Newtown Pike (Exit 115, I-75), Lexington, KY 40517 Tel 859/455-5000 800/EMBASSY Fax 859/455-5001 www.embassy-suites.com

The Embassy Suites offers a versatile floor plan for groups of all sizes and features a large ballroom. Enjoy full made-to-order breakfasts and evening cocktails in a lovely location near picturesque Bluegrass horse country and convenient to interstate highways.

Name of Room	Square Feet	Capacity			
		Theatre Style	Classroom Style	Banquet	Reception
Coldstream Ballroom	8,064	800	400	550	800
I	1,152	95	45	60	100
II	1,152	95	45	60	100
III	3,456	300	180	240	300
IV	1,152	95	45	60	100
V	1,152	95	45	60	100
Fayette	720	75	40	50	50
Bourbon	720	75	40	50	50
Clark	792	75	50	50	60
Boardrooms (Keeneland, Lexington, Paris, Georgetown, Versailles)	520	16 person capacity			

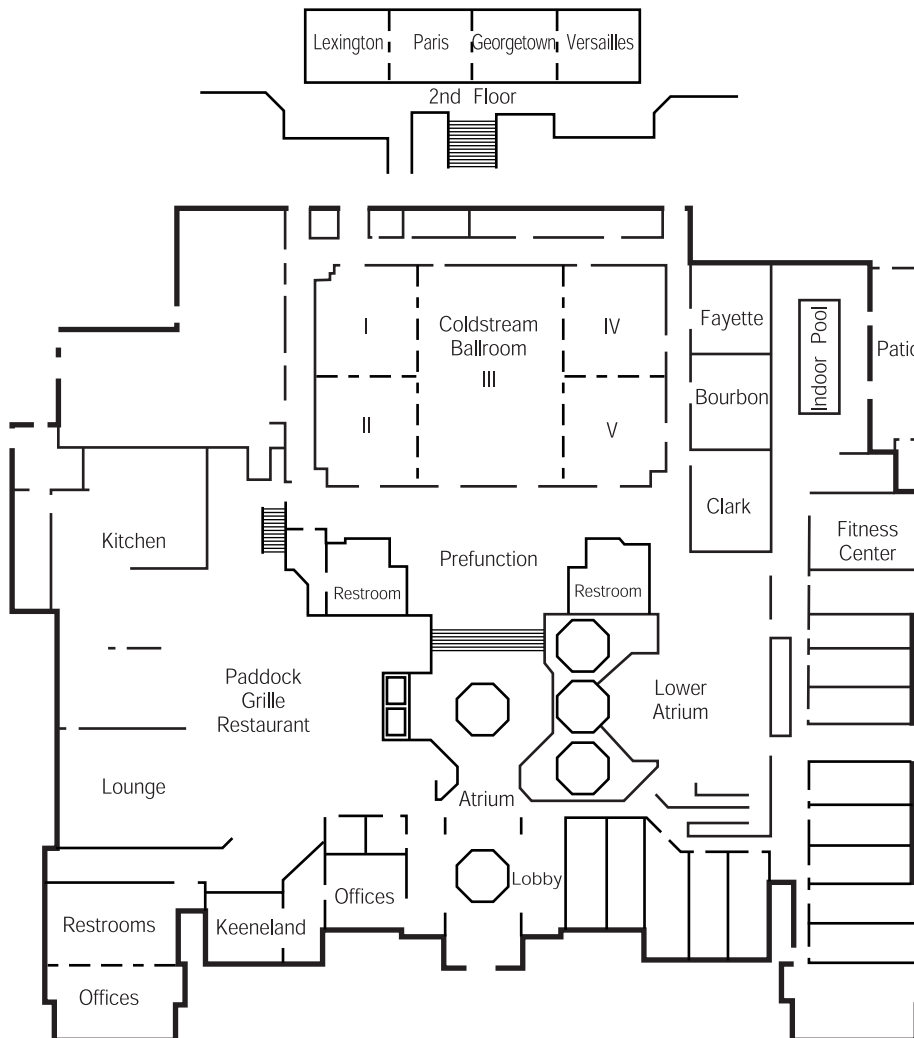

Four Points Sheraton

1938 Stanton Way (Exit 115, I-75), Lexington, KY 40511 Tel 859/259-1311 Fax 859/233-3658 www.fourpoints.com

A full-service business class hotel with free high-speed internet, the Four Points Sheraton is conveniently located near Bluegrass horse farms and interstate highways. Its versatile mix of meeting rooms, breakout rooms and prefunction space accommodates a wide variety of events.

Name of Room	Square Feet	Capacity			
		Theatre Style	Classroom Style	Banquet	Reception
Salon A	500	40	25	40	53
Salon B	994	100	45	70	105
Salon C	994	100	45	70	105
Salon D	2,688	300	120	170	253
Salons B & C	1,988	200	90	120	210
Salons B, C & D	4,676	475	275	300	475
Salon E	484	40	25	40	47
Salon F	484	40	25	40	40
Salon G	979	105	45	70	100

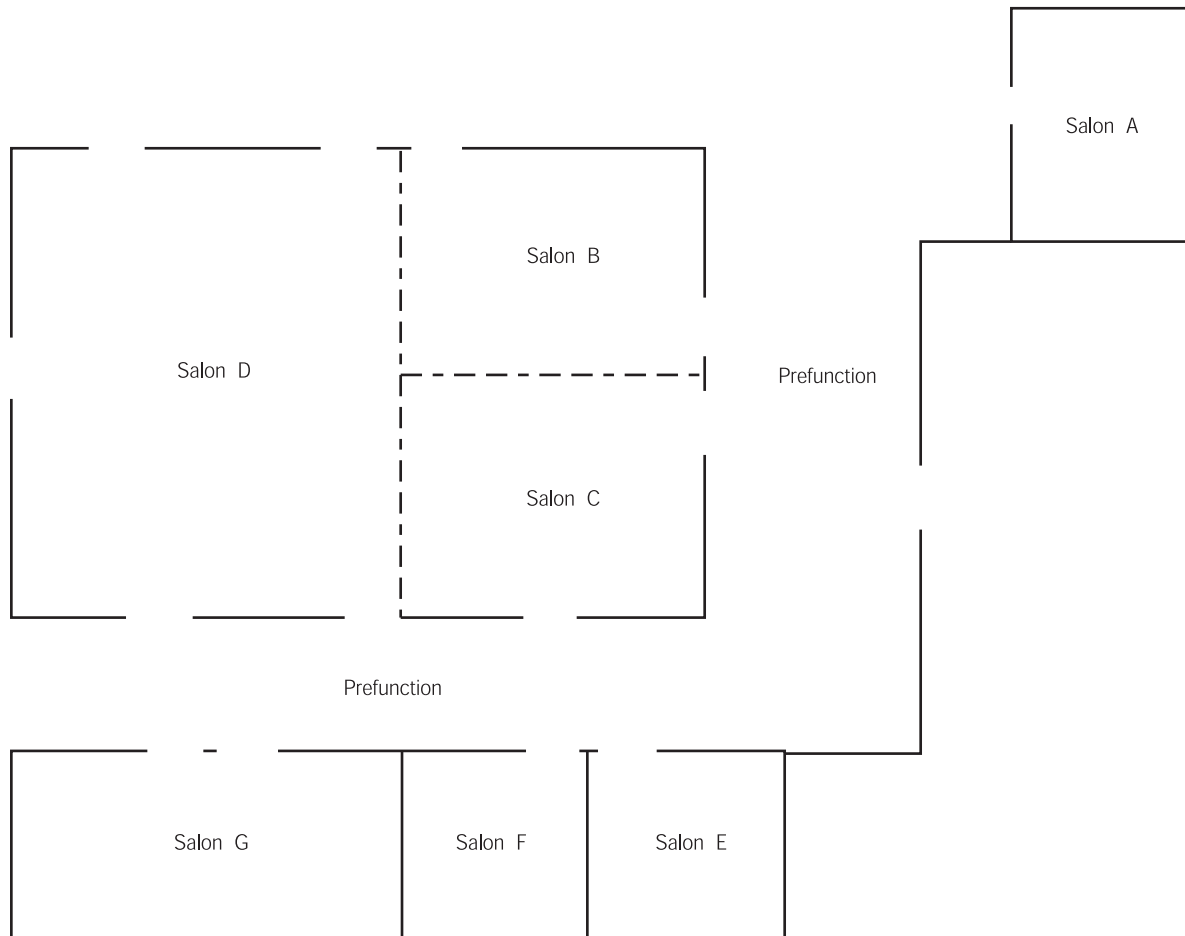

Griffin Gate Marriott Resort

1800 Newtown Pike (Exit 115, I-75), Lexington, KY 40511 Tel 859/231-5100 800/831-4004 Fax 859/288-6265 www.griffingatemarriott.com

Kentucky's only 4-star, 4-diamond resort, Griffin Gate features an 18-hole championship golf course and the widely acclaimed Mansion restaurant. Lots of flexible meeting rooms and salons offer comfort for groups large or small and ample space and ceiling height for exhibitors. There are two additional meeting rooms located in the Mansion. Spa opening in 2007.

Name of Room	Square Feet	Capacity				Ceiling Height	Exhibit (8x10)
		Theatre Style	Classroom Style	Banquet	Reception		
Grand Ballroom	9,570	1,200	560	930	1,370	12'	45
Salon A	500	40	22	40	50	12'	—
Salon B	640	55	25	40	50	12'	—
Salon C	1,798	200	112	150	250	14'	—
Salon D	1,798	200	112	150	250	14'	—
Salon E	1,856	200	112	150	250	14'	—
Salon F	1,856	200	112	150	250	14'	—
Salon G	513	50	38	40	50	12'	—
Salon H	589	50	22	40	50	12'	—
Calumet	528	50	25	40	50	10'	—
Darby Dan	528	50	25	40	50	10'	—
Dixiana	528	50	25	40	50	10'	—
Lanes End	528	50	25	40	50	10'	—
Elmendorf	459	12 person capacity				10'	—
Spendthrift	1,050	90	70	80	120	10'	—
Saxony	673	50	25	50	80	8'	—
Bluegrass Pavilion	4,200	—	—	370	400	—	—

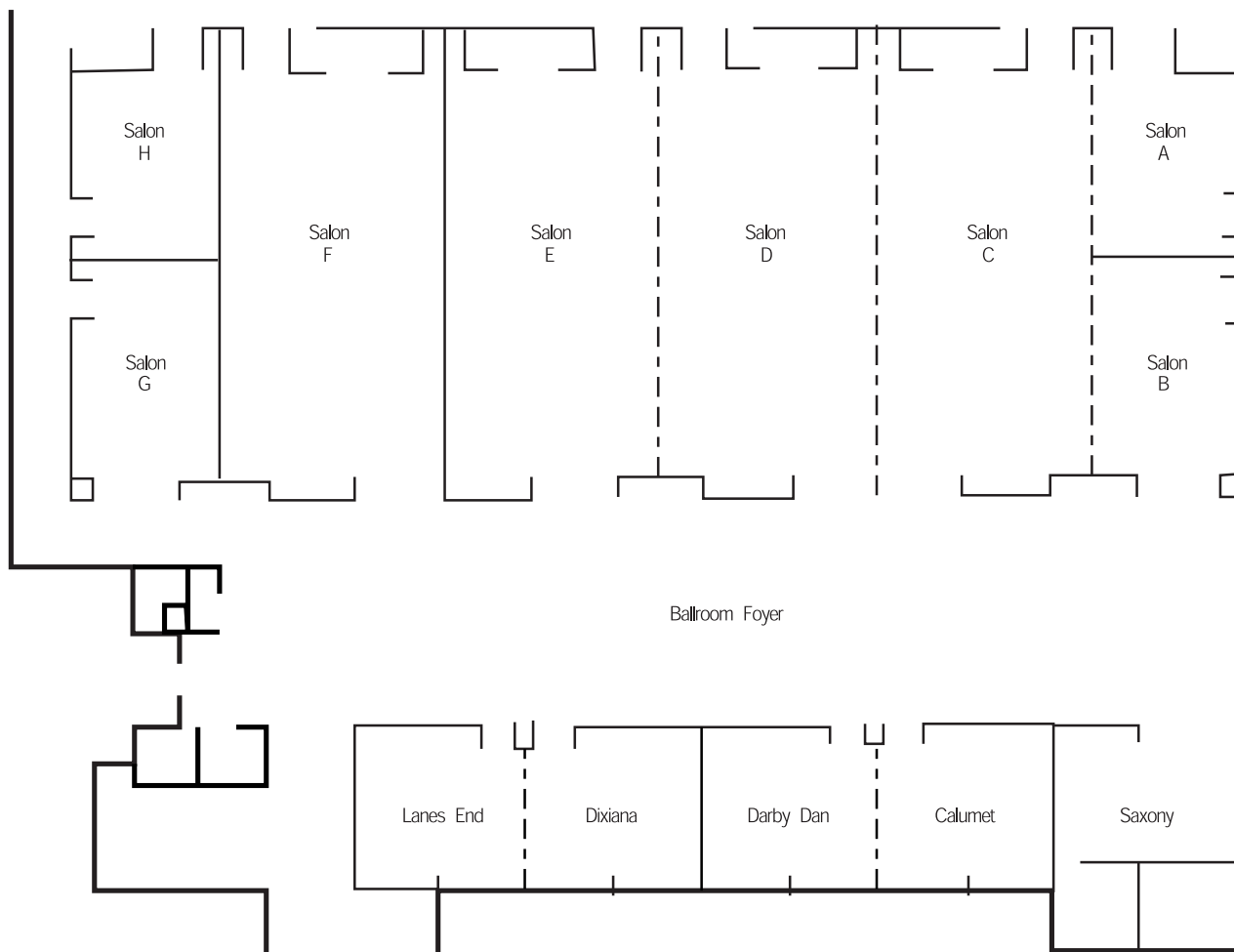

Hilton Suites Lexington Green

245 Lexington Green Circle, Lexington, KY 40503 Tel 859/271-4000 800/445-8667 Fax 859/273-2975 www.lexingtongreen.hilton.com

Lexington's premier, all-suite hotel, located next to shopping, dining, cinemas, a comedy club and the region's largest retail mall.

On-site amenities for business visitors include high-speed internet access, restaurants and lounges, a health club, meeting rooms and boardroom suites to accommodate a variety of meeting needs.

Name of Room	Square Feet	Capacity			
		Theatre Style	Classroom Style	Banquet	Reception
Ballroom					
Rooms A-D	1,560	140	108	120	200
Rooms A-C	1,170	105	72	80	—
Rooms A&B	780	70	40	48	—
Room A	390	35	18	24	—
Sky Lobby	1,066	100	48	112	130
Balcony Areas (9)	560	32	24	24	—

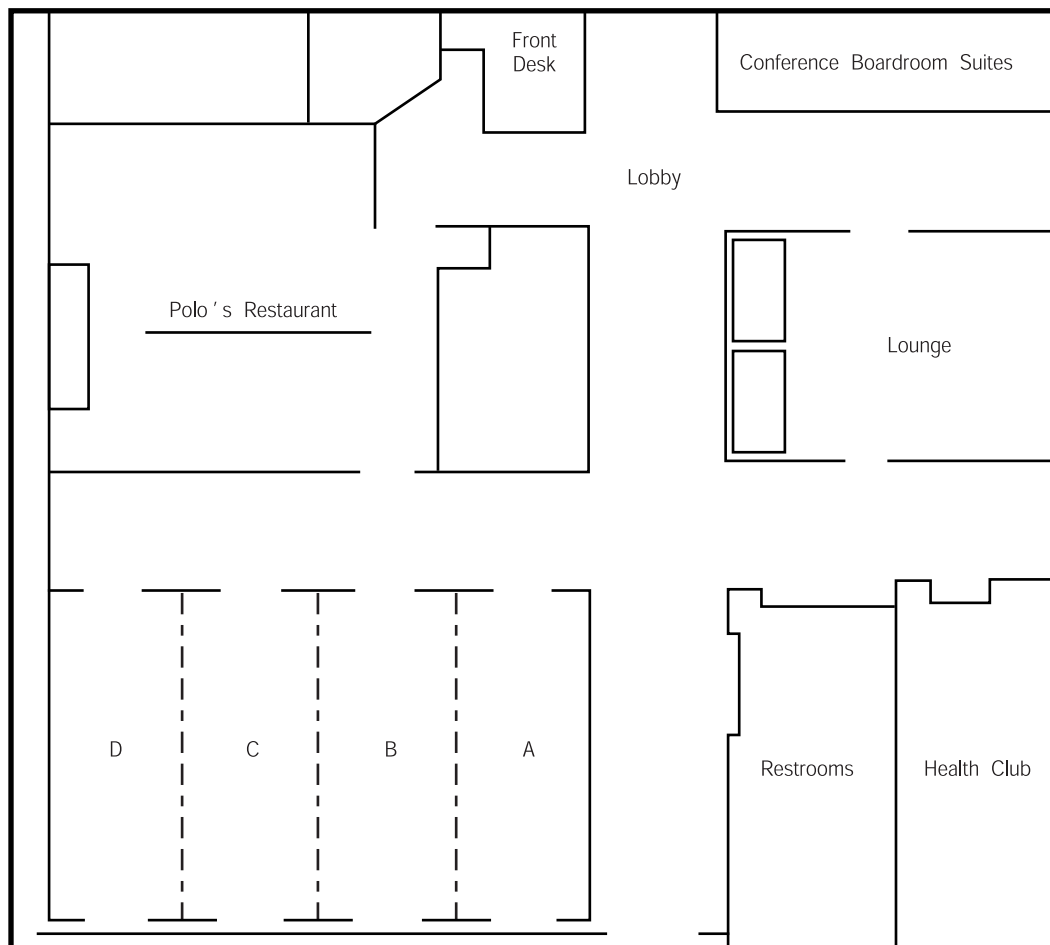

Holiday Inn North

1950 Newtown Pike (Exit 115, I-75), Lexington, KY 40511 Tel 859/233-0512 800/HOLIDAY Fax 859/259-0982 www.hilexingtonnorth.com

Holiday Inn North is located minutes from downtown just off the interstate convenient to Keeneland, the University of Kentucky and the Kentucky Horse Park. Hotel features 302 rooms (with three suites), Mandolins Bar & Grill, the Post Restaurant, plus the Holidome and 10,000 square feet of meeting space. Upgraded guest rooms feature Tempur Pedic® bedding and microwave/refrigerator units.

Name of Room	Square Feet	Capacity				Ceiling Height	Exhibit (8x10)
		Theatre Style	Classroom Style	Banquet	Reception		
Bluegrass Pavilion	6,893	860	425	450	800	12'	57
Preakness	1,647	200	90	100	200	12'	20
Derby	1,708	200	90	100	200	12'	20
Belmont	1,708	200	90	100	200	12'	20
Man-O-War	580	45	35	40	50	12'	7
Secretariat	608	45	35	40	50	12'	7
Thoroughbred	608	45	35	40	50	12'	7
Henry Clay	504	40	25	30	40	12'	5
Claiborne	504	40	25	30	40	12'	5
Lexington	625	45	35	40	50	12'	5
Keeneland	625	45	35	40	50	12'	5

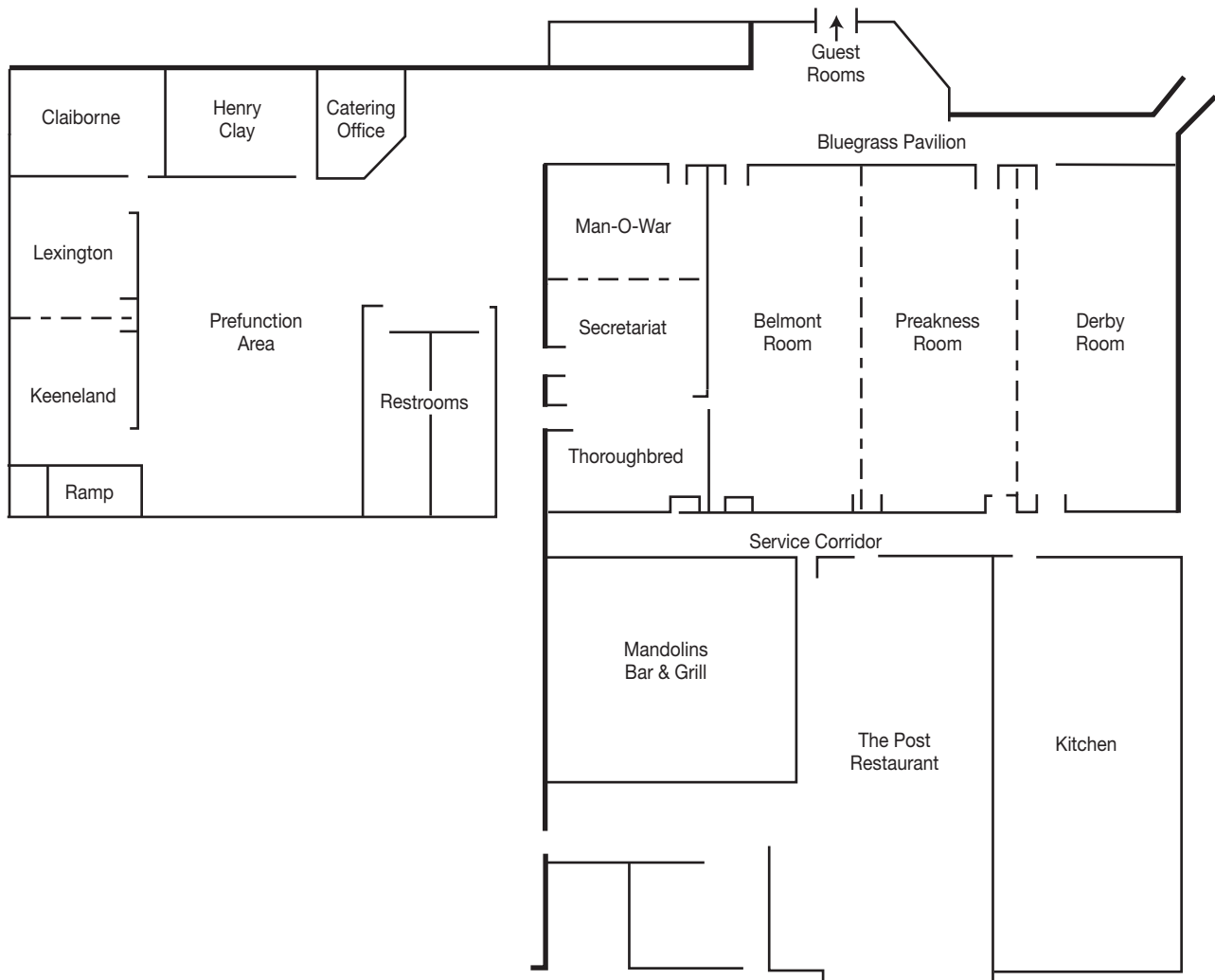

Holiday Inn South

5532 Athens-Boonesboro Road (Exit 104, I-75), Lexington, KY 40509 Tel 859/263-5241 800/HOLIDAY Fax (859) 263-4333
www.holiday-inn.com/lexington-s

This full-service hotel is conveniently located off I-75 on Lexington's south side and offers 5,500 square feet of function space. Amenities include a health club and an indoor pool.

Name of Room	Square Feet	Theatre Style	Classroom Style	Capacity	
				Banquet	Reception
Triple Crown Ballroom (Combined)	3,440	350	180	250	300
Belmont	1,200	120	60	110	125
Derby	1,120	115	60	95	125
Preakness	1,120	115	60	95	125
Keeneland & Red Mile	672	50	30	30	50
Keeneland	336	25	12	15	25
Red Mile	336	25	12	15	25
Man-O-War	612	60	24	40	50
Terrace Dining	350	—	—	20	20
Paddock Board Room	240				

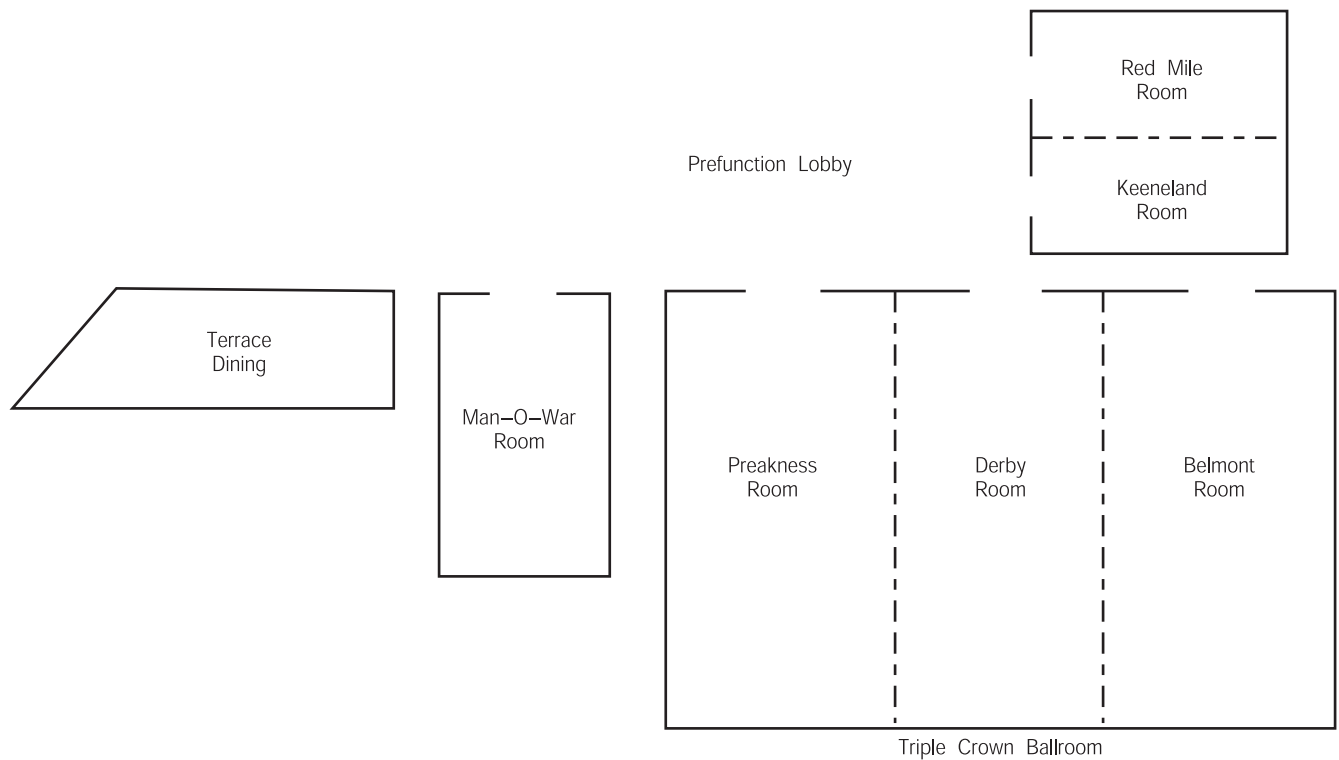

Hyatt Regency Lexington

401 West High Street, Lexington, KY 40507 Tel 859/253-1234 800/233-1234 Fax 859/254-7430 www.lexington.hyatt.com

Connected to the Lexington Convention Center and Rupp Arena, the Hyatt offers the convenience and color of downtown Lexington with the amenities of a first-class hotel. The Hyatt offers over 19,000 square feet of flexible meeting space, featuring a restaurant, exercise facility and an indoor pool.

Name of Room	Square Feet	Capacity				Ceiling Height	Exhibit (8x10)
		Theatre Style	Classroom Style	Banquet	Reception		
Patterson Ballroom A-H	9,100	975	600	700	900	17'-10'	60
Patterson A	924	100	63	80	100	17'	—
Patterson B	1,400	175	100	130	150	17'	—
Patterson C	1,400	175	100	130	150	17'	—
Patterson D	1,764	200	110	140	175	17'-10'	—
Patterson E	500	55	40	30	40	7'10"	—
Patterson F	560	50	30	30	35	7'10"	—
Patterson G	580	45	30	30	40	7'10"	—
Patterson H	420	50	24	20	30	10'	—
Meeting Rooms	1,640	150	100	90	100	7'10"	—
Prefunction	1,860	—	—	—	100	7'10"	—
Prefunction/open	3,500	—	—	—	300	10'-8'	—
Regency Ballroom	4,000	500	310	400	500	14'6"	25
2/3 Ballroom	2,700	340	190	250	300	14'6"	—
1/2 Ballroom	2,000	250	140	200	250	14'6"	—
1/3 Ballroom	1,300	170	90	100	150	14'6"	—
Mary Todd Lincoln	—	—	—	16	16	7'6"	—
Henry Clay	—	—	—	16	16	7'6"	—
Hyatt Suites (Washington, San Francisco, Chicago, Atlanta)	2,100	200	120	160	180	7'10"	—
3/4 Suite	1,575	150	90	110	120	7'10"	—
1/2 Suite	1,050	100	60	80	90	7'10"	—
1/4 Suite	525	50	30	30	30	7'10"	—
Hyttops	2,726	—	—	—	225	10'	—
Kentucky	2,544	—	—	140	200	10'7"	—

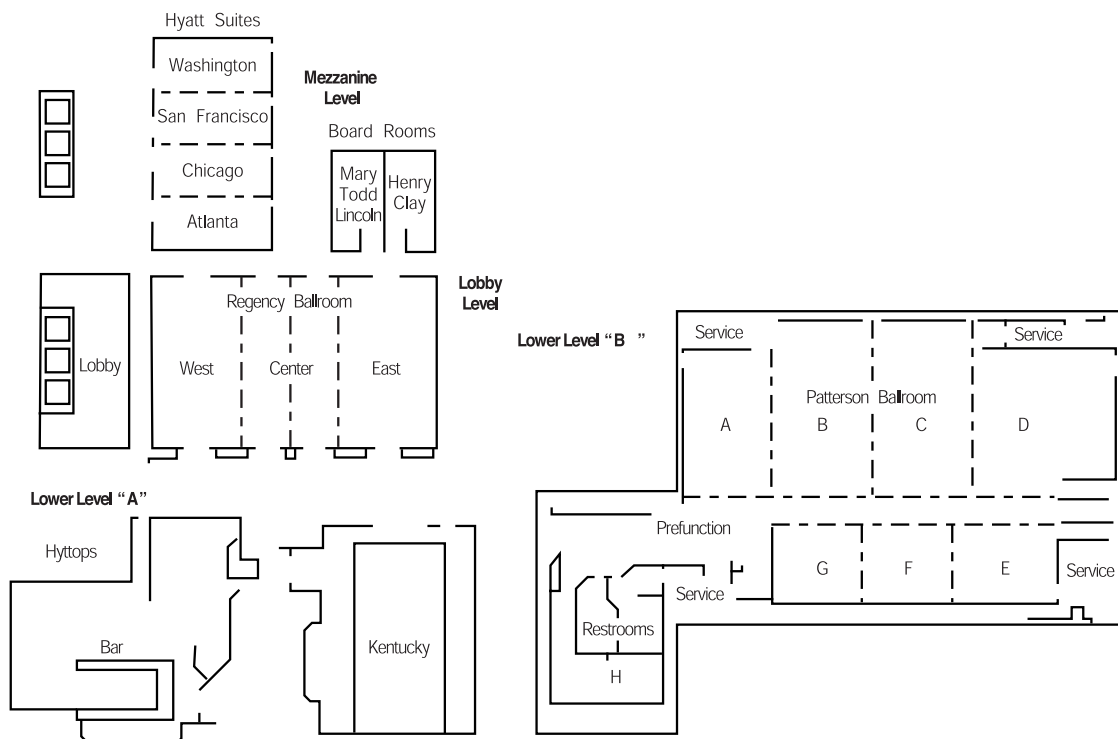

Meetings & Conventions Hotels

The Kentucky Inn

525 Waller Avenue, Lexington, KY 40504 Tel 859/254-1177 800/221-6652 Fax 859/252-4913

The Kentucky Inn offers business class accommodations and intimate meeting rooms for small groups. It is conveniently located to the University of Kentucky, downtown, Keeneland, Red Mile and the airport. A continental breakfast is complimentary every day.

Name of Room	Square Feet	Capacity			
		Theatre Style	Classroom Style	Banquet	Reception
Lexington	3,600	350	150	200	—
Regency	1,330	150	50	60	—
Bluegrass	1,040	100	50	50	—
Fireside	1,036	100	40	50	—
University	700	50	20	30	—
Essex	10 person capacity				

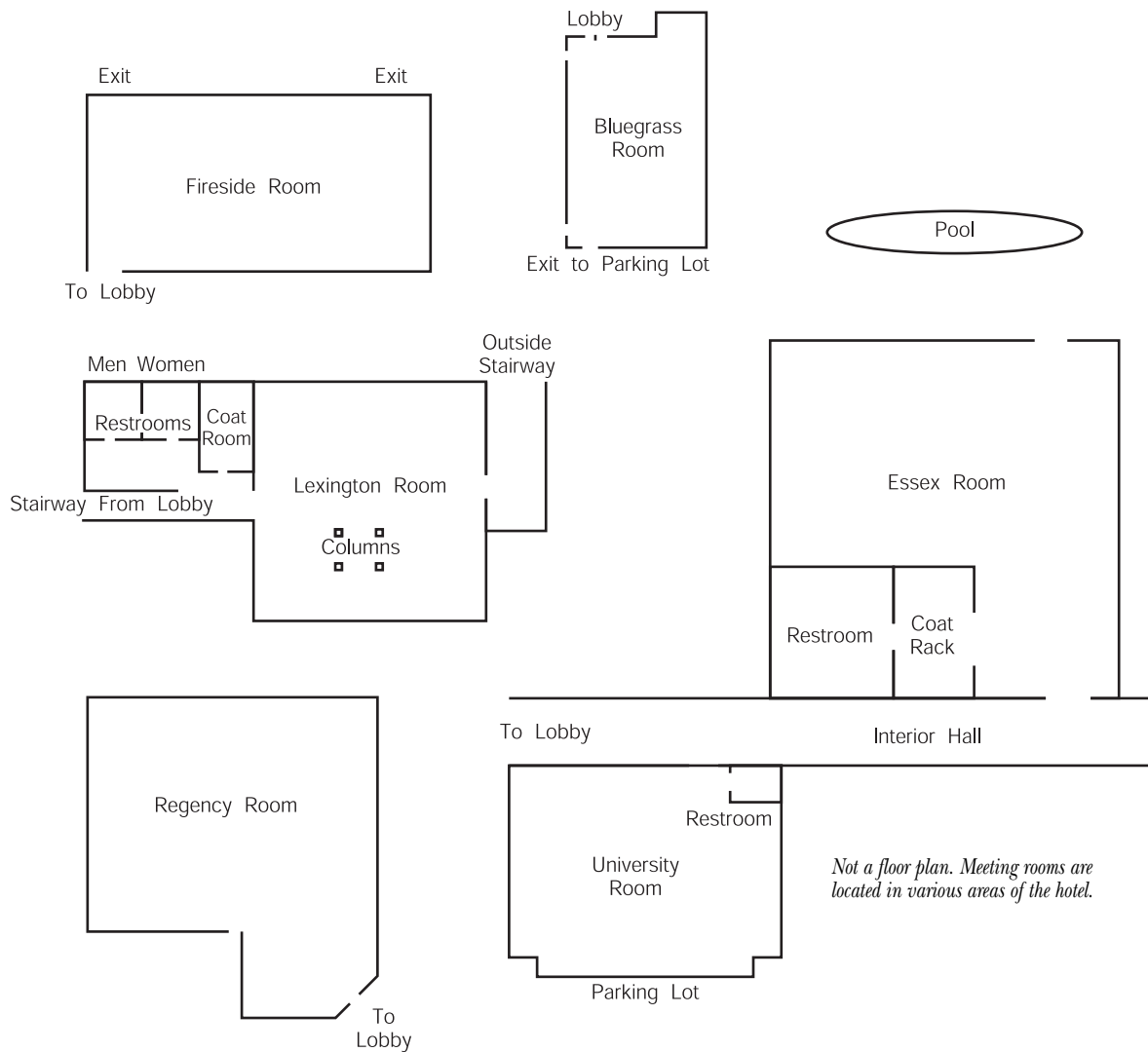

Radisson Plaza Hotel

369 West Vine Street, Lexington, KY 40507 Tel 859/231-9000 800/333-3333 Fax 859/281-3704 www.radisson.com/lexingtonky

A luxurious downtown property, the Radisson Plaza Hotel is located within walking distance of shopping, restaurants and entertainment. This full-service hotel features a restaurant, martini bar, shops on the premises and a health club.

Name of Room	Square Feet	Capacity				Ceiling Height	Exhibit (8x10)
		Theatre Style	Classroom Style	Banquet	Reception		
Grand Ballroom	6,850	1,000	450	680	1,000	10'-20'	46
Ballroom I	1,500	150	96	150	150	10'	—
Ballroom II	1,800	175	108	150	175	20'	—
Ballroom III	1,650	150	96	150	150	20'	—
Ballroom IV	1,800	175	108	150	175	10'	—
Abraham Lincoln	1,539	160	72	120	160	8'6"	—
Lincoln I	810	60	36	60	60	8'6"	—
Lincoln II	729	55	36	50	55	8'6"	—
Daniel Boone	1,232	100	66	100	100	8'6"	—
Boone I	308	25	9	20	25	8'6"	—
Boone II	638	50	48	50	50	8'6"	—
Boone III	308	25	9	20	25	8'6"	—
Clay	594	50	36	40	50	8'6"	—
1/2 Clay	308	25	9	20	25	8'6"	—
Breckinridge	594	50	36	40	50	8'6"	—
1/2 Breckinridge	308	25	9	20	25	8'6"	—
Davis	462	35	21	30	35	8'6"	—
Burley	475		12 person capacity			8'6"	—
Black Diamond	714		16 person capacity			8'6"	—
Kincaid	630	50	36	50	50	11'6"	—
Prefunction	2,600	—	—	—	680	—	—
Window Box	—	—	—	50	60	—	—
Pool	1,390	—	—	120	150	10'6"	—
Spirits	855	—	45	60	150	9'	—

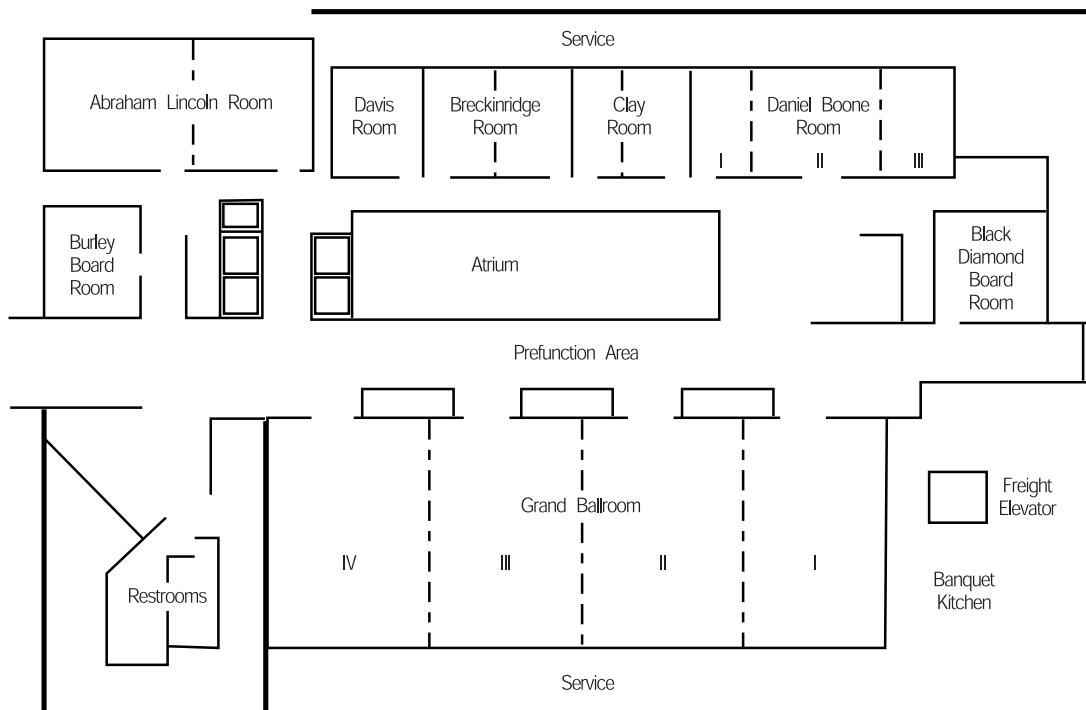

Ramada Conference Center

2143 North Broadway, Lexington, KY 40505 Tel 859/299-1261 800/2-RAMADA Fax 859/293-0048 Email: ramadainnlexky@aol.com
 Appeal abounds at the Ramada Inn Conference Center with its location convenient to the interstate, airport and some of the most picturesque horse farms in the Bluegrass.

Name of Room	Square Feet	Capacity			
		Theatre Style	Classroom Style	Banquet	Reception
Ballroom	2,888	352	192	256	280
East/Center	1,976	240	132	160	200
West/Center	1,786	216	120	128	160
East	1,064	128	72	80	100
West	874	104	60	64	80
Center	874	104	60	64	80
Lexington	984	50	30	40	50
Kentucky	984	80	66	64	80
Directors	750	50	32	48	50
Stephen Foster (120)*	600	40	24	24	30
Henry Clay (220)*	600	40	24	24	30
Bluegrass (243)*	600	40	24	24	30
Presidential (396)*	600	25	12	16	25

*All Parlor Suites

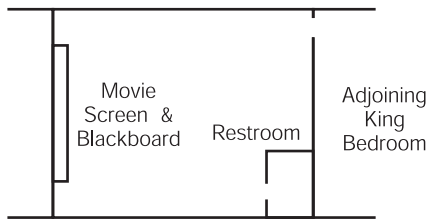

Kentucky Suite

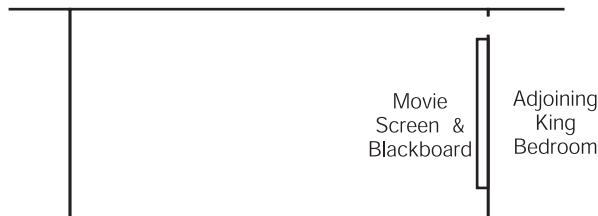

Lexington Suite

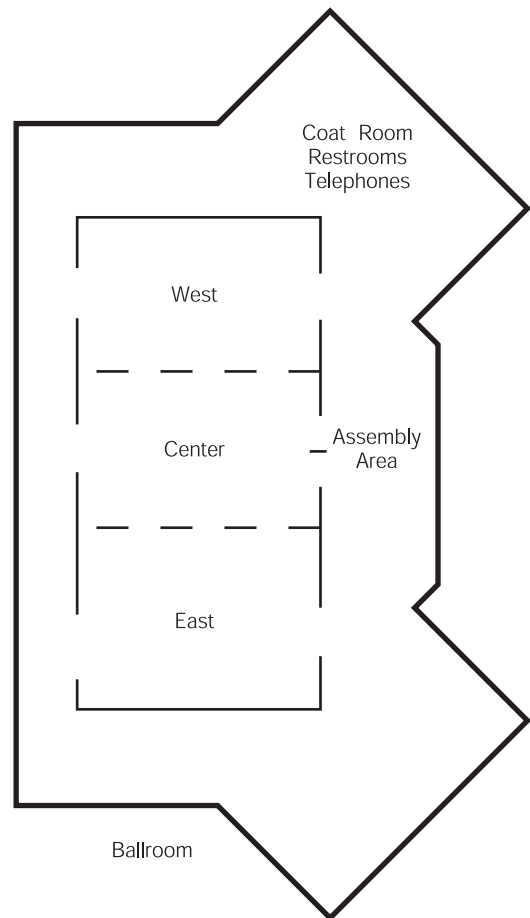
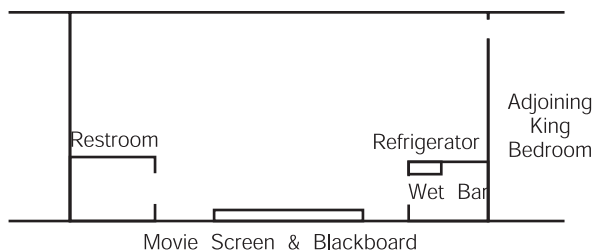

Sheraton Suites Lexington

2601 Richmond Road, Lexington, KY 40509 Tel 859/268-0060 800/262-3774 Fax 859/268-6209 www.sheraton.com/lexington

The Sheraton Suites offers guests the convenience of a suite hotel and the ambiance of first-class accommodations. The two-story lobby is modeled after the French Quarter, complete with a fountain and stone floors. There's a restaurant, a mix of meeting rooms and prefunction space, along with versatile fully accommodated two-room suites.

Name of Room	Square Feet	Capacity			
		Theatre Style	Classroom Style	Banquet	Reception
Mardi Gras Ballroom	2,280	300	150	220	300
1 Section	570	50	40	40	40
2 Sections	1,178	150	70	80	80
3 Sections	1,762	210	120	150	150
Deauville Room	1,515	180	100	100	140
LaFitte Board Room	380		16 person capacity		
Versailles Board Room	380		16 person capacity		
New Orleans	500	40	24	30	40

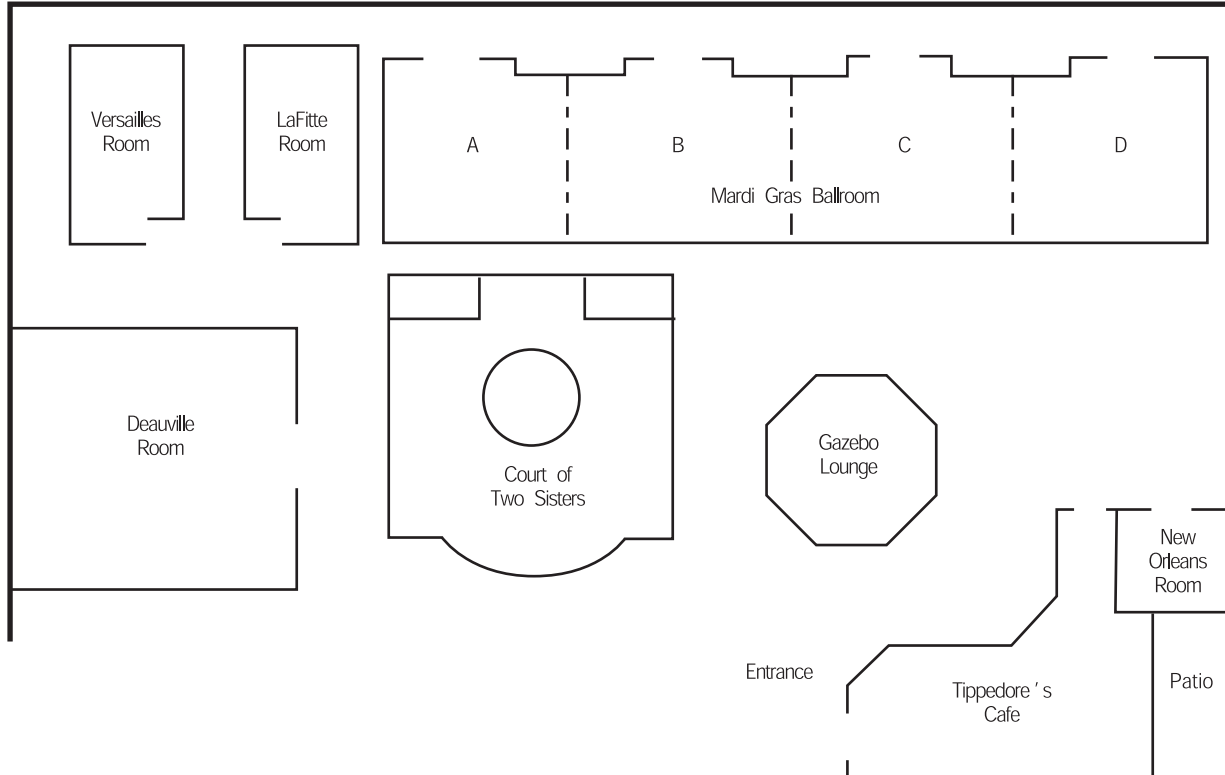

SpringHill Suites

863 South Broadway, Lexington, KY 40504 Tel 859/225-1500 Fax 859/225-1534 www.marriott.com/lexsh

One of Lexington's newest properties, this hotel is adjacent to the Red Mile Harness Track and just 5 minutes from downtown.

Name of Room	Square Feet	Theatre Style	Capacity		
			Classroom Style	Banquet	Reception
Bluegrass A	660	75	36	50	—
Bluegrass B	330	33	12	20	—
Bluegrass A & B	990	115	54	80	75

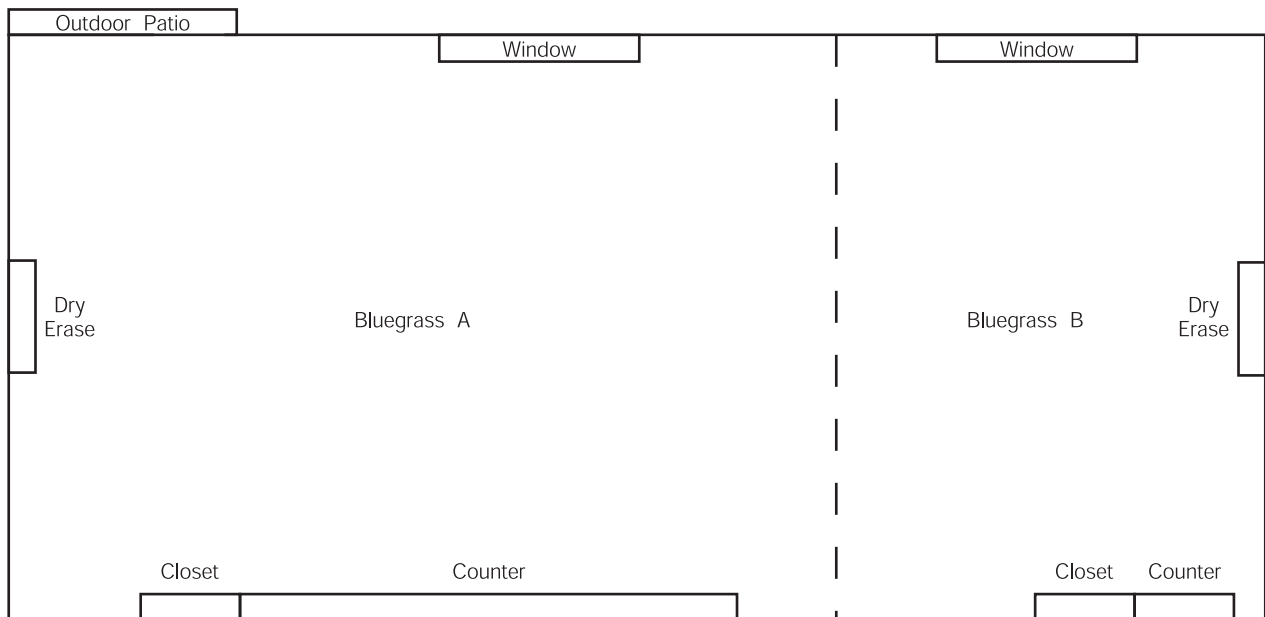

The Springs Inn

2020 Harrodsburg Road, Lexington, KY 40503 Tel 859/277-5751 800/354-9503 Fax 859/277-3142

A Lexington tradition since 1948, the Springs Inn is family owned and operated. Perfect for a small meeting or event, the hotel treats guests to traditional Kentucky dining, an entertainment lounge and banquet facilities all in a central Lexington location.

Name of Room	Square Feet	Capacity			
		Theatre Style	Classroom Style	Banquet	Reception
Ballroom	2,900	275	125	270	175
East Room	966	80	40	75	40
Fayette Room	966	80	40	75	40
West Room	966	80	40	75	40
Kentucky Room	1,935	250	100	200	110
Lexington Room	378	30	20	—	—
Chandler Room	576	—	—	45	—
Harrodsburg Room	936	75	40	60	60
Bluegrass Club Room	1,150				60
Directors Room	216		12 person capacity		
Board Room	176		12 person capacity		

