

Lexington Convention Center

430 West Vine Street, Lexington KY 40507 Tel 859/233-4567 Fax 859/253-2718 www.lexingtoncenter.com

Located in the heart of colorful downtown, the newly renovated Lexington Convention Center offers 66,000 square feet of exhibition space and 40,000 square feet of meeting rooms and ballrooms, all adjacent to the Civic Center Shops and Rupp Arena, home court of the Kentucky Wildcats. The Convention Center and two convenient full-service hotels occupy a common corner next door to many of Lexington's exciting downtown shopping, dining and entertainment destinations.

Name of Room	Square Feet	Capacity				Ceiling Height	Exhibit (8x10)	Exhibit (10x10)
		Theatre Style	Classroom Style	Banquet	Reception			
East	18,000	2,145	1,245	1,300	2,000	20'-37"*	120	107
Center	18,000	2,145	1,245	1,300	2,000	20'-37"*	120	107
West	30,000	3,310	2,125	2,160	3,300	20'-37"+	202	172
Total	66,000	7,320	4,480	5,070	7,300	20'-37"+	454	388
Heritage BR 1	1,980	150	103	120	205	16'	—	—
Heritage 2	2,160	202	152	150	225	16'	—	—
Heritage 3	2,285	202	152	150	230	16'	—	—
Heritage 1-3	6,534	560	407	440	660	16'	34	34
Heritage Prefunction	8,600	—	—	—	950	26'10"	—	—
Elkhorn MR A	1,100	96	60	90	—	15'	—	—
Elkhorn B	1,170	112	60	90	—	15'	—	—
Elkhorn C	1,170	112	60	90	—	15'	—	—
Elkhorn D	1,100	96	60	90	—	15'	—	—
Elkhorn A-B	2,270	224	120	150	—	15'	—	—
Elkhorn C-D	2,270	224	120	150	—	15'	—	—
Elkhorn All	4,540	448	240	300	—	15'	—	—
Berea Room	1,000	93	58	70	—	—	—	—

*Maximum entrance width 14' †Maximum entrance width 18'

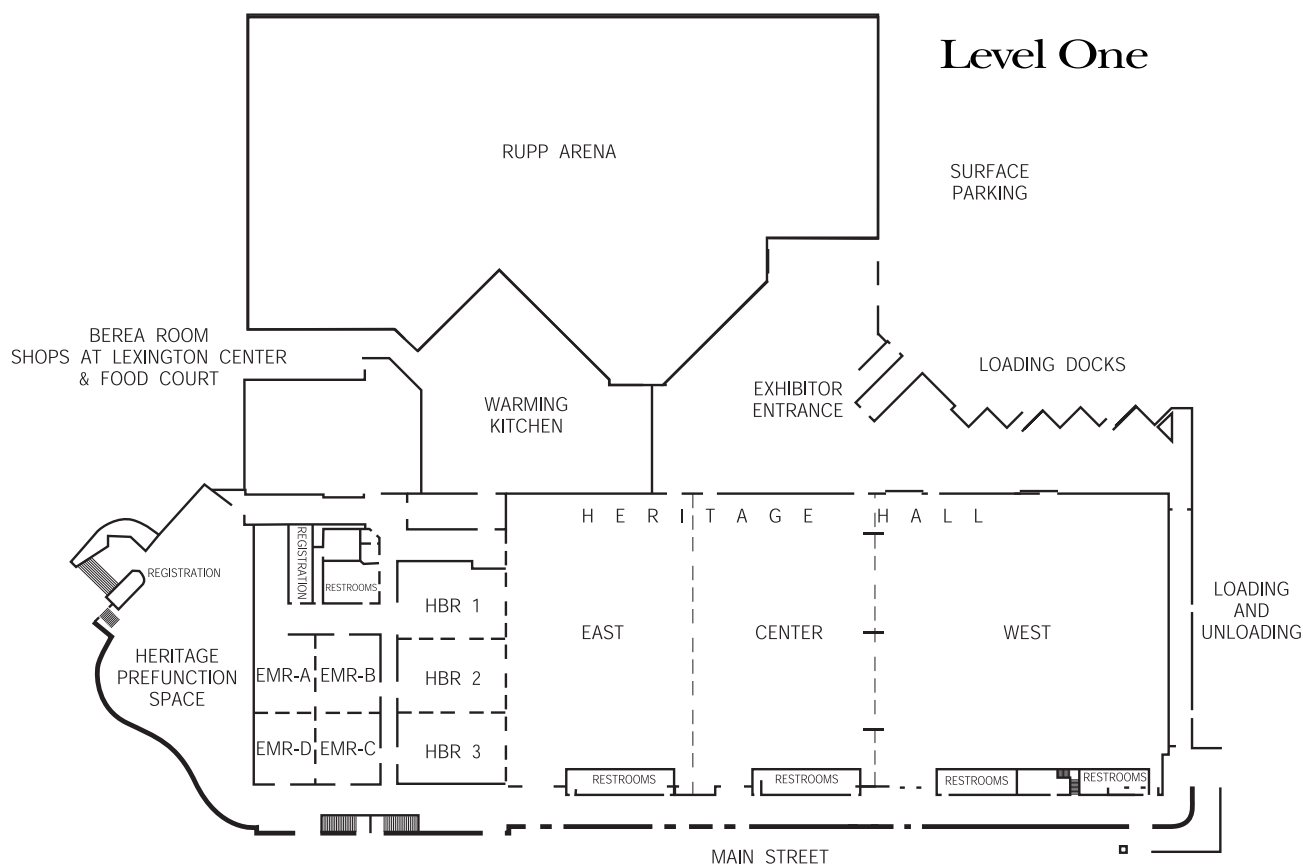

Lexington Convention Center

430 West Vine Street, Lexington KY 40507 Tel 859/233-4567 Fax 859/253-2718 www.lexingtoncenter.com

Name of Room	Square Feet	Capacity				Ceiling Height	Exhibit (8x10)	Exhibit (10x10)
		Theatre Style	Classroom Style	Banquet	Reception			
Bluegrass Ballroom 1	8,190	928	528	560	—	22'	—	—
Bluegrass Ballroom 2	8,880	1,000	528	640	—	22'	—	—
Bluegrass Ballroom	17,070	1,900	1,050	1,200	1,900	22'	114	98
Bluegrass Prefunction	8,800	—	—	—	950	14'9"	—	—
Thoroughbred 1	2,546	288	165	180	—	16'	—	—
Thoroughbred 2	1,254	120	84	90	—	16'	—	—
Thoroughbred 3	1,254	120	84	90	—	16'	—	—
Thoroughbred 2-3	2,546	288	165	180	—	16'	—	—
Thoroughbred 1-3	5,400	576	330	390	600	16'	—	—
Thoroughbred Prefunction	3,400	—	—	—	370	15'4"	—	—
Thoroughbred 4	1,872	205	119	120	—	16'	—	—
Thoroughbred 5	806	84	48	50	—	16'	—	—
Thoroughbred 6	806	84	48	50	—	16'	—	—
Thoroughbred 7	806	84	48	50	—	16'	—	—
Thoroughbred 5-7	2,418	252	144	150	—	16'	—	—
Thoroughbred 8	828	76	36	50	—	16'	—	—

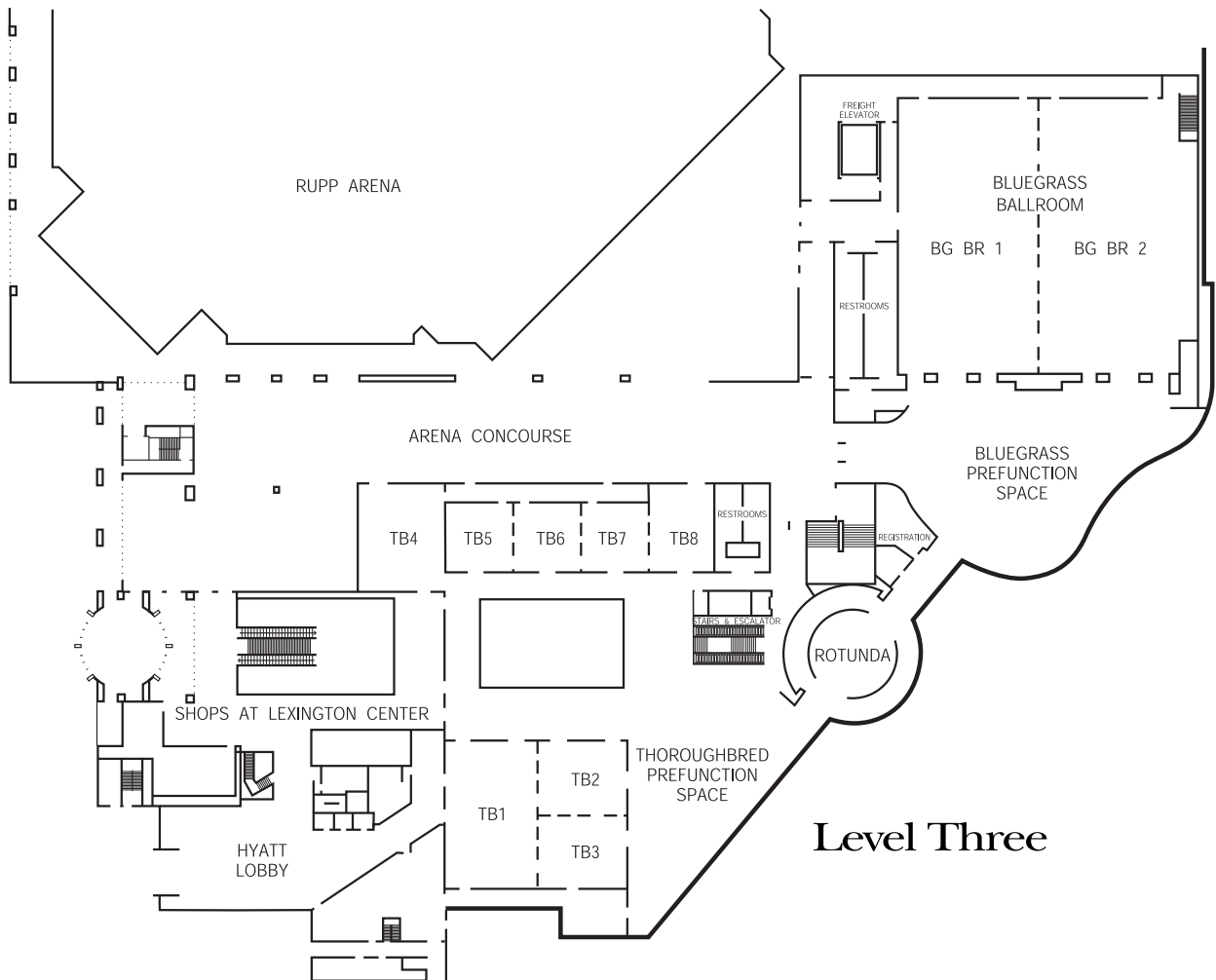

Level Three

Lexington Convention Center – Rupp Arena

430 West Vine Street, Lexington KY 40507 Tel 859/233-4567 Fax 859/253-2718 www.lexingtoncenter.com

Name of Room	Square Feet	Capacity				Size	Ceiling Height
		Theatre Style	Classroom Style	Banquet	Reception		
Rupp Arena	–	23,400	–	–	–	–	–
Rupp Arena Floor	25,000	2,000	1,200	1,200	2,500	96' x 245'	85'*

*Maximum entrance width 16'

Seating Capacity: meeting and stage event set-up options include seating for

- | | | |
|----------|-----------|-----------|
| 1. 2,500 | 4. 7,500 | 7. 23,400 |
| 2. 3,500 | 5. 10,000 | |
| 3. 5,000 | 6. 17,000 | |

Sound System: capable of 80 microphones with recording studio quality

Dressing Room: 8 features and 5 choral rooms

Stage: adjustable from 4' to 6' high

Loading: via 7 loading docks or direct access to the floor

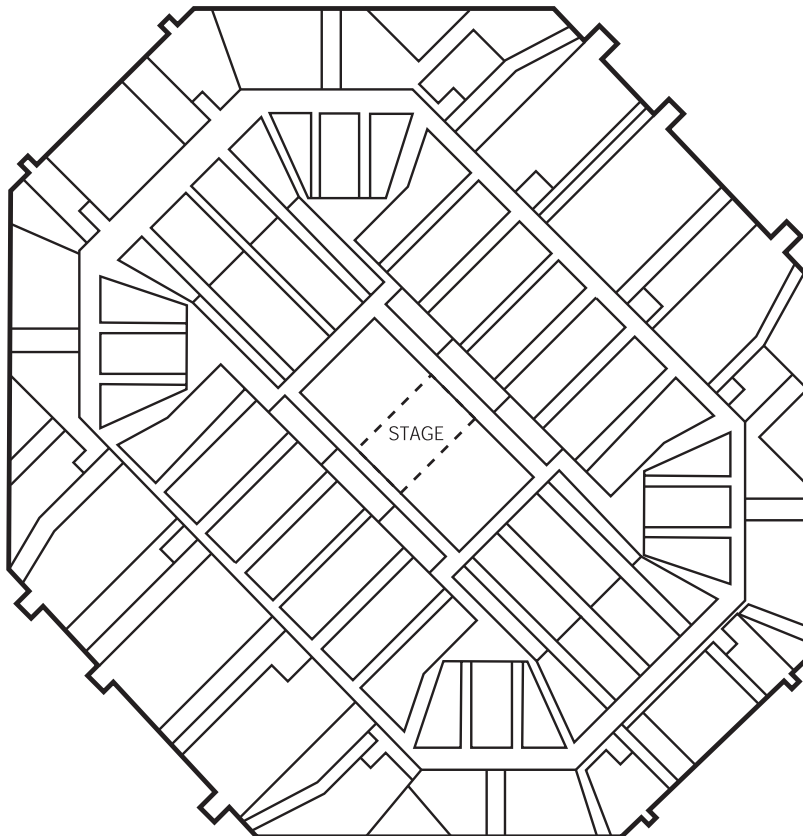

This 23,400 seat arena has gained attention from the major meeting industry, annually hosting a wide range of large events.

Famous as the home of University of Kentucky Wildcat basketball, Rupp Arena also houses enthusiastic crowds as a stop for many major-city concert tours and touring family shows.